

SMART CLEANER CS-LC

End face cleaner for CS® and LC connectors

Cleaner: **SCK-SS-CS**

Refill: **SCK-SS-CS-R**



CABLE ASSEMBLY



NETWORK EQUIPMENT



FIELD INSTALLATIONS



ENGINEERING & RESEARCH
LABS

FEATURES:

- Cleans 750 end faces
- Cleans both LC and CS® connectors in adapters and unmated assemblies.
- Key features of cleaning tip open most internal shutter LC adapters
- RoHS and REACH compliant with no shelf life or restrictions on storage or shipments
- Works for UPC and APC polished end faces.
- Using the replacement refill cartridges for reducing cost per clean
- Refills are sold 3 to a box
- Cleaner locks up at end of life to alert operator

DIMENSIONS:

Length: 25.0 cm (9.8 in)
Width: 3.0 cm (1.2 in)
Height: 4.0 cm (2.0 in)
Weight: 57 g (2 oz)

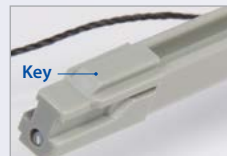
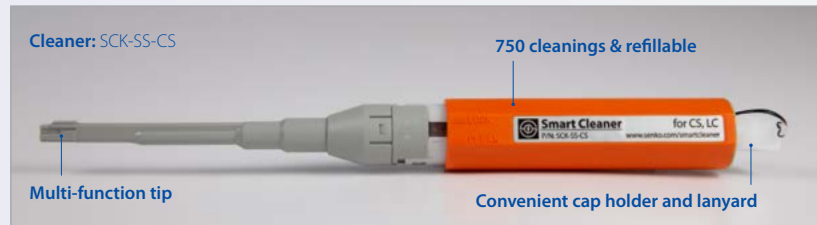

Key enables cleaning for both LC and CS connectors



Dual spines for high stability while cleaning



Duplex connector compatibility



Cleaning for LC connectors

Adapter LC End Face Cleaning



1. Place the white end cap into the handle.
2. Insert the cleaner into the adapter port and push forward 1X to clean the end face.

Unmated LC End Face Cleaning

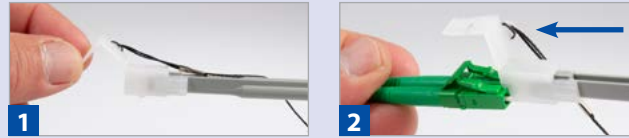

1. Open the lid on the white end cap.
2. Insert into the LC connector and push cleaner forward 1x to clean the end face.

Cleaning for CS duplex connectors

Adapter CS Duplex End Face Cleaning



1. Place the white end cap into the handle.
2. Turn the key 90° and insert into the port and push 1X to clean the end face.
3. Turn the key 180° and insert into the port and push 1X to clean the end face

Unmated CS Duplex End Face Cleaning



1. Open the lid on the white end cap.
2. Insert into the CS duplex connector and push cleaner forward 1x to clean the end face.
3. Turn the key 180° then insert into the CS duplex connector and push cleaner forward 1x to clean the end face.

Refill replacement:

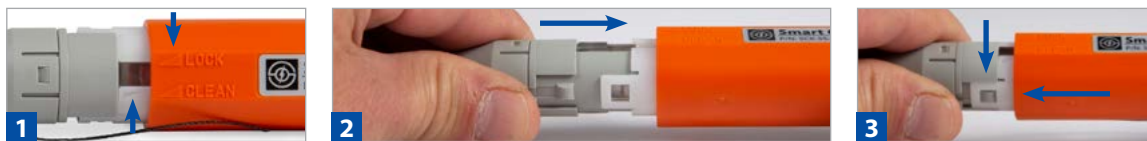

1. Rotate the orange handle to align the two arrows to go into "Lock Mode".
2. Hold the orange handle stationary and pull back on the gray cleaning cartridge
3. Place the replacement cartridge into the orange handle. Make sure to align the gray bump into the slots of the white mounting ears in the handle.

AMERICAS

US EAST 1.888.32.SENKO | Sales-Americas@senko.com
US WEST 1.858.623.3300
TEXAS 1.972.661.9080

BRAZIL

BRAZIL +55.21.3736.7065 | Sales-Brazil@senko.com

AUSTRALIA & PACIFIC REGION

Australia +61.0.3.9755.7922 | Sales-Asia-Pacific@senko.com

JAPAN

TOKYO +81.0.3.5825.0911 | Sales-Japan@senko.com

ASIA

HONG KONG +852.2121.0516 | Sales-Asia@senko.com
SHANGHAI +86.21.5830.4513
SHEZHEN +86.755.2533.4893

EUROPE

UK +44(0)1256 700880 | Sales-uk@senko.com
POLAND +44(0) 7796444488
SPAIN & PORTUGAL +34 678042829 | Sales-Iberia@senko.com
GERMANY +49(0)15117683072 | Sales-Germany@senko.com
ITALY +39 338 8919089 | Sales-Italy@senko.com
FRANCE +44 7939364565 | Salesfrance@senko.com
OTHER +44(0) 1256 700880 | Sales-Europe@senko.com

SENKO[®]
Advanced Components
senko.com